



Grosvenor Waterside, Chelsea
London SW1W

GARTONJONES.COM

Grosvenor Waterside, Chelsea London, SW1W

GARTON JONES.COM

8 Gatliff Road
Chelsea
London
SW1W 8DP

Lettings:
+44 (0) 20 7730 5007
gws@gartonjones.com
www.gartonjones.com

£850 Per Week

A bright and spacious 2 bedroom furnished apartment for to rent of approx. 889sq.ft (83sq.m) in Hepworth Court, one of the buildings forming the popular Grosvenor Waterside development located close to the banks of the River Thames by Chelsea Bridge. This well presented property further benefits from an open plan reception room with an integrated kitchen, there are 2 balconies, 2 bathrooms (1 en-suite), wood flooring, comfort cooling and good storage. As a resident you will have use of a 24 hour concierge and a smart gym with spa facilities, there is an on-site Sainsbury's, a coffee shop and bakery, crèche and a Purple Dragon private kids club. You will also be within walking distance to the transport links, shops, bars and restaurants of both Sloane Square and Victoria mainline station and Gatwick Express.

Please note the furniture may differ or not be included to that shown in current photos.

ZERO DEPOSIT AVAILABLE

- 889sq.ft (83sq.m)
- 2 Bedrooms
- Open Plan Reception Room
- Kitchen with Integrated Appliances
- 2 Bathrooms (1 En-Suite)
- 2 Balconies
- 24 Hour Concierge
- Residents Gym & Leisure Facilities
- On-Site Sainsbury's, Coffee Shop, Creche & Purple Dragon Private Kids Club
- Walking Distance to the Transport Links of Sloane Square & Victoria



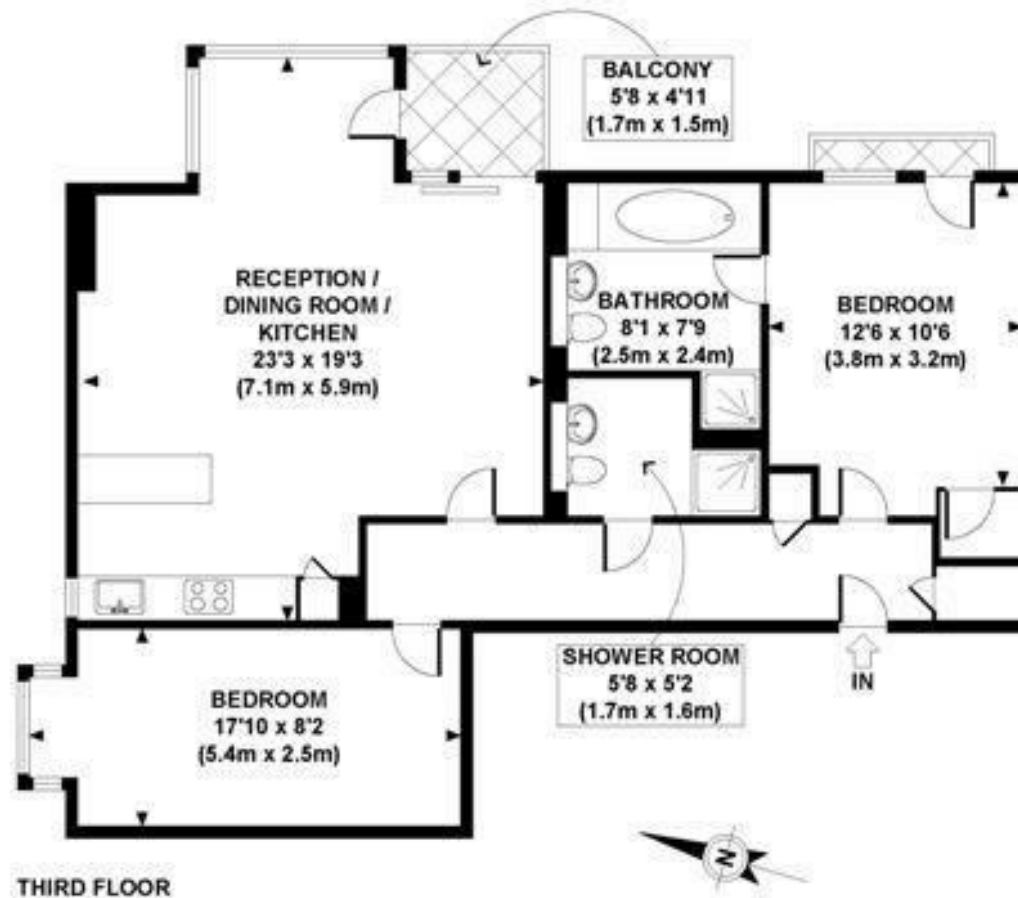

THIRD FLOOR
GROSS INTERNAL
FLOOR AREA 889 SQ FT

APPROX. GROSS INTERNAL FLOOR AREA 889 SQ FT / 83 SQ M

GJW - 091008

Copyright photoplan.co.uk

Floorplans are for identification and guideline purposes only, not to scale.

Compliant with RICS code of measuring practice.

